

BSS 162 Smart Classroom Instructions

If you are having difficulties using equipment in this room, call extension **3166**

Powering On the Computer and Projector

- 1) Press the **Power** button on the computer and the **ON button** on the white console control panel.
- 2) If it is not lit, press the **Computer** button on the white console control panel.
- 3) Press the **Projector** button on the white console control panel.
- 4) If the computer and console fail to power up, check the **main power switch** located at the bottom of the cabinet, which should be glowing red.

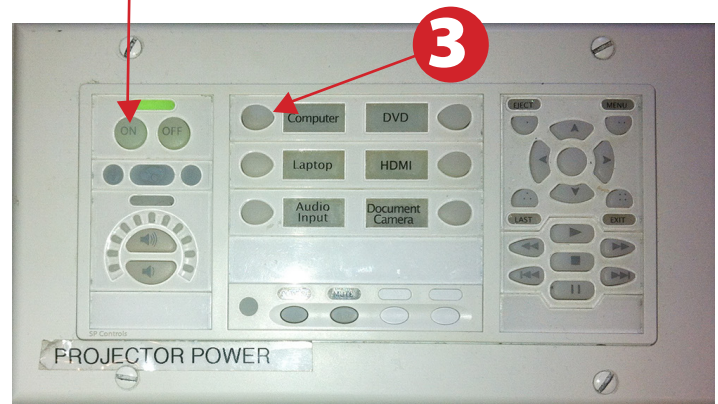
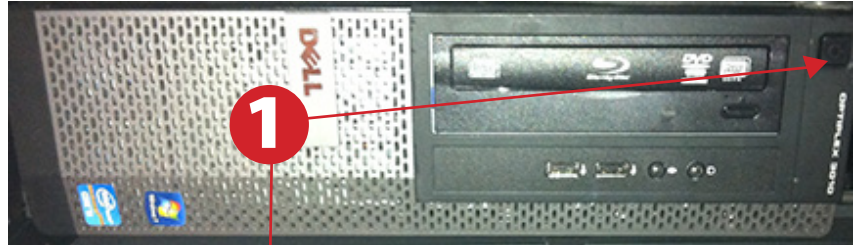

Using a Laptop

- 1) Shut down your laptop.
- 2) Connect the **Laptop Video cable** to the video output port on your laptop.
Please note: the Laptop Video cable is VGA-compatible only. Certain laptop models will require a DVI-to-VGA adaptor, a Mini-VGA adaptor, or a DisplayPort-to-VGA adaptor. Consult your owner's manual for further information.
- 3) For Internet connectivity, connect the **green laptop network cable** to your laptop.
Please note: you will need to "register" your laptop before connecting to the campus network. Contact your college ITC or the Help Desk for further information.
- 4) For laptop audio output, connect the **laptop audio cable** to your laptop's headphone jack. Make sure your laptop's audio is not muted.
- 5) Press the **Laptop button** on the on the white console control panel.
- 6) Connect your laptop's AC adaptor to a power outlet and start up your laptop.
- 7) If you still do not see an image, refer to **laptop troubleshooting guide** on page 3.
- 8) When finished, shut down your laptop and disconnect all cables.



Using the Blu-Ray/DVD Player

1) Press the **DVD button** on the white console control panel. This will illuminate the controls on the right-hand side of the white console control panel.

2) Press the **Eject button** on the white control panel and insert your Blu-Ray or DVD. Press the **Eject button again** to retract the tray and begin playback. Use the buttons on the white control panel (Menu, Fast Forward, etc.) to control playback. When finished, press **Eject** and retrieve your disc, then press **Eject** one last time to retract the tray.

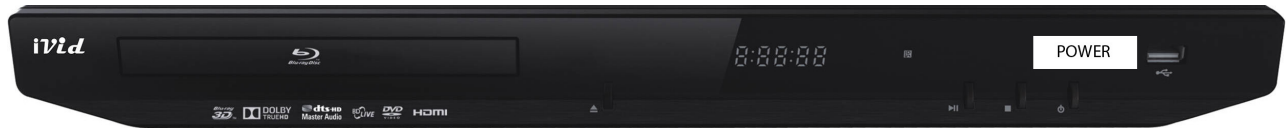
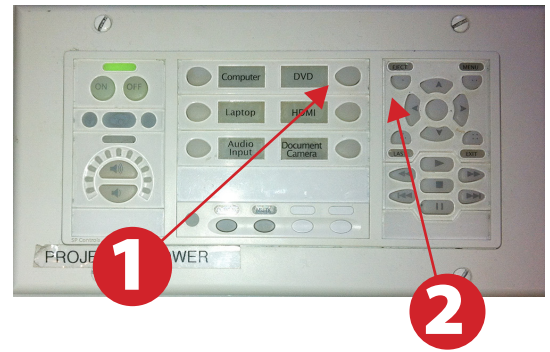

Using an HDMI device

An HDMI cable is provided for connecting devices such as some laptops, iPads/iPhones and Android devices.

1) Set video control panel to **HDMI**

2) Connect your device to the **HDMI cable**.



Please note: Certain devices, such as iPhones and iPads, will require an HDMI adaptor. Consult your owner's manual for further information.

Laptop Troubleshooting

For PC Laptops: Depending on your model of laptop, you may need to toggle the display mode. For example, on many laptops, you must hold down the **function key (FN)** located in the lower left-hand corner of the keyboard, and at the same time, press the **video toggle key**, which is located along the top of the keyboard. Look for the text **CRT/LCD** or an icon of a **display and a laptop**.



Examples of video toggle keys

For Mac Laptops:

- 1) Go to **System Preferences/Display**.
- 2) Select the **Arrangement** tab and check the **Mirror Displays** box.

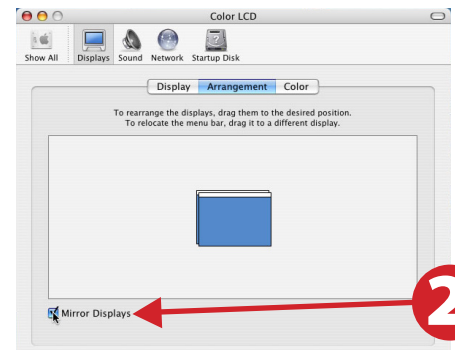

Using the Document Camera

1) Press **Document Camera** on the white control panel.

2) Power on the **Document Camera**.

Note that the Document Camera overrides the computer, and there is no need to have the computer turned on to use the document camera.

3) Press the **Live/Win** button to switch between showing the Windows desktop and showing the camera image full-screen.

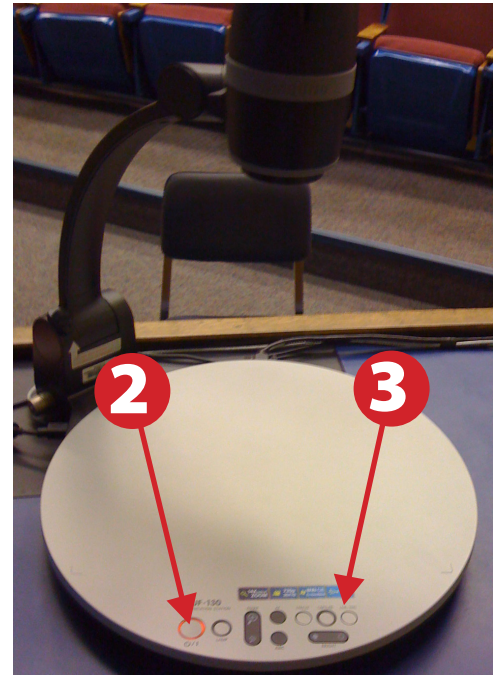
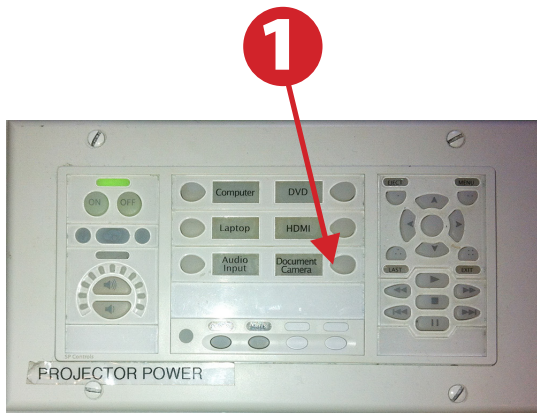

Powering Down the System

1) Power down computer.
Go to **Start Menu -> Shut Down -> Click OK**

2) Press the **Off button** on the white control panel.



These instructions are applicable to the following Smart Classrooms:

BSS 162

Fall 2016