

Smart Classroom Instructions

WILDLIFE 258

If you are having difficulties using equipment in this room, call extension **3166**

Projector

- 1) Press the On button on the console controls
- 2) Lower screen
- 3) Press button for desired device - Computer, Laptop, Audio Input, HDMI, Document Camera



Using Console Computer

- 1) Select **Computer** on the console controls.
- 2) Press **Power** button (in the upper right corner)
- 3) Follow login instructions for:
 - Windows**
 - a. Control - Option - Delete
 - b. Click OK
 - c. Enter user name and password
 - d. Click Enter



Using a Laptop

- 1) Turn on your laptop.
- 2) Set console control box to:
Laptop
- 3) Connect the **Laptop Video cable** to the video output port on your laptop.
- 4) Connect the **audio cable** to the headphone port on your laptop.
- 5) Connect your laptop's AC adaptor to a power outlet and start up your laptop.
- 6) If you still do not see an image, refer to the **laptop troubleshooting guide** later in these instructions.
- 7) When finished, shut down your laptop and disconnect all cables.
- 8) Proceed to shutting down the rest of the equipment. Follow the instructions later in this guide, **Powering Down the System**.



Sound Input

Playing Audio

- 1) Select **Audio Input** from the console controls
- 2) Plug the audio cable into your device's audio output jack
- 3) Adjust volume as needed



Playing a DVD/Blu-Ray

- 1) Press **DVD** on the white control panel.
- 2) Insert media
- 3) Use the remote control to utilize features.



Using an HDMI Device

An HDMI cable is provided for connecting devices such as some laptops, iPads/iPhones and Android devices.

- 1) Set display switch box to **HDMI**.



- 2) Connect your device to the HDMI cable.



Please note: Certain devices, such as iPhones and iPads, will require an HDMI adaptor. Consult your owner's manual for further information.

Using the Document Camera

- 1) Set display switch box to **Doc Camera**.
- 2) Power on the **Document Camera**. Note that there is no need to have the computer turned on to use the document camera.
- 3) Press the **Live/Win** button to switch between showing the Windows desktop and showing the camera image full-screen.



Laptop Troubleshooting

For PC Laptops: Depending on your model of laptop, you may need to toggle the display mode. For example, on many laptops, you must hold down the **function key (FN)** located in the lower left-hand corner of the keyboard, and at the same time, press the **video toggle key**, which is located along the top of the keyboard. Look for the text **CRT/LCD** or an icon of a **display and a laptop**.

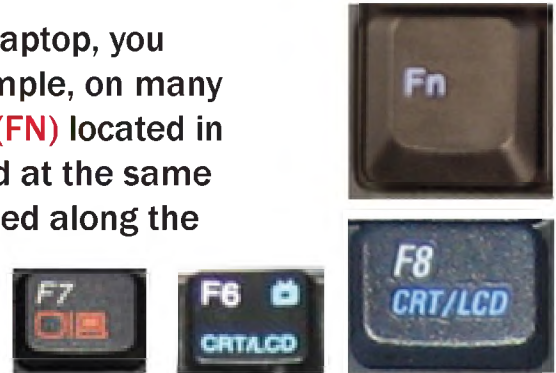

Examples of video toggle keys

For Mac Laptops:

- 1) Go to **System Preferences/Display**.
- 2) Select the **Arrangement** tab and check the **Mirror Displays** box.

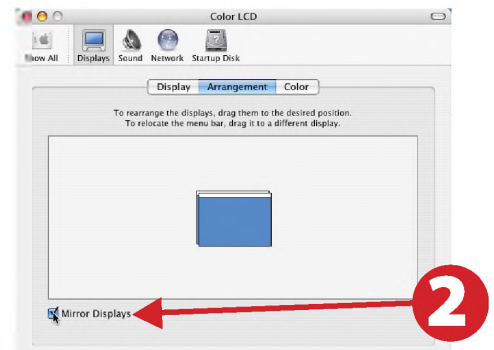

Powering Down the System

- 1) Press the Off button on the console controls
- 2) Power down Computer

Windows

Start Menu -> Shut Down -> Click OK

- 3) Raise screen



Who to Call for Assistance

If you are having any difficulties using equipment in this room, call extension **3166**