

BSS 162 Smart Classroom Instructions

If you are having difficulties using equipment in this room, call extension **3166**

Powering On the Computer and Projector

- 1) Press the **Power** button on the computer and press **Start** on the tablet
- 2) Press **Projector Power** to turn on projector
- 3) If the computer and console fail to power up, check the **main power switch** located at the bottom of the cabinet, which should be glowing red



Using a Laptop or HDMI Device

- 1) Turn on your laptop
- 2) Connect the **Laptop Video cable** or **HDMI** to the video output port on your laptop
- 3) For laptop audio output, connect the **laptop audio cable** to your laptop's headphone jack. Make sure your laptop's audio is not muted
- 4) Drag **HDMI Laptop** to projector source.
- 5) If you still do not see an image, refer to **laptop troubleshooting guide** later in this guide
- 6) When finished, shut down your laptop and disconnect all cables



Please note: Certain devices, such as iPhones and iPads, will require an HDMI adaptor. Consult your owner's manual for further information.

Using the Blu-Ray/DVD Player

- 1) Drag the **Blu-Ray icon** to projector source
- 2) Insert your Blu-Ray or DVD and begin playback. Use Blu-Ray controls screen to control playback

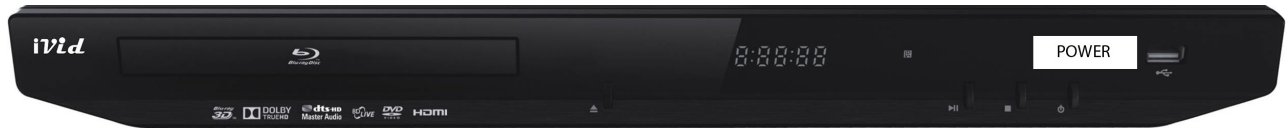

Using the Document Camera

- 1) Drag **Doc Camera** to center
- 2) Power on the **Document Camera**. Note that there is no need to have the computer turned on to use the document camera



Laptop Troubleshooting

For PC Laptops: Depending on your model of laptop, you may need to toggle the display mode. For example, on many laptops, you must hold down the **function key (FN)** located in the lower left-hand corner of the keyboard, and at the same time, press the **video toggle key**, which is located along the top of the keyboard. Look for the text **CRT/LCD** or an icon of a **display and a laptop**.



Examples of video toggle keys

For Mac Laptops:

- 1) Go to **System Preferences/Display**
- 2) Select the **Arrangement** tab and check the **Mirror Displays** box

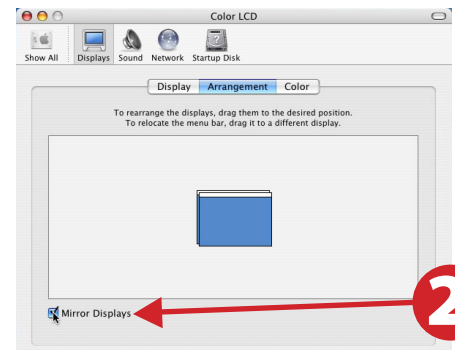

Powering Down the System

- 1) Power down computer.
Go to **Start Menu -> Shut Down -> Click OK**
- 2) Press the **Power** button on tablet, then press **Yes**



These instructions are applicable to the following Smart Classrooms:

BSS 162

Fall 2019