

Smart Classroom Instructions

BEHAVIORAL & SOCIAL SCIENCES 166

If you are having difficulties using equipment in this room, call extension **3166**

Projector

- 1) Press **Start** to activate tablet
- 2) Press **Main Projector Power** to turn on the projector for the middle screen.
Press **Side Projector Power** to turn on projectors for the two side screens
- 3) **Drag** Computer, Blu-Ray, HDMI, etc. to the **box in the left** for the main projector, or the **box on the right** for the side projectors. You can have multiple sources on multiple screens this way.



Using Console Computer

- 1) Slide Computer to the main/side projector (or both.)
- 2) Press **Power** button (in the upper right corner)
- 3) Follow login instructions for:
Windows
 - a. Control - Option - Delete
 - b. Click OK
 - c. Enter user name and password
 - d. Click Enter



Using a Laptop or HDMI Device

- 1) Shut down your laptop.
- 2) Drag **Wireless** or **HDMI Laptop** to main or side projector (or both)
- 3) Connect the **Laptop Video cable** or **HDMI cable** to the video output port on your laptop.
- 4) Connect your laptop's AC adaptor to a power outlet and start up your laptop.
- 5) If you still do not see an image, refer to the **laptop troubleshooting guide** later in these instructions.
- 6) When finished, shut down your laptop and disconnect all cables. Please set the video switch back to **Computer** for both projectors.
- 7) Proceed to shutting down the rest of the equipment. Follow the instructions later in this guide, **Powering Down the System**.



Using the Document Camera

- 1) Drag **Doc Camera** icon to the center of the tablet
- 2) Power on the **Document Camera**. Note that there is no need to have the computer turned on to use the document camera



Blu-Ray/DVD

- 1) Drag **Blu-Ray icon** to main, side (or both) projectors
- 2) Insert media
- 3) Press **Blu-Ray controls** to access controls.

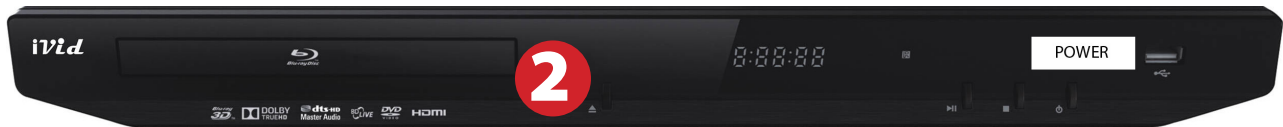
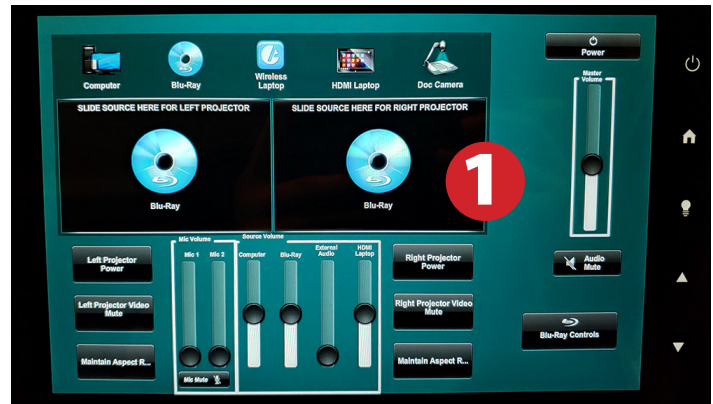

Laptop Troubleshooting

For PC Laptops: Depending on your model of laptop, you may need to toggle the display mode. For example, on many laptops, you must hold down the **function key (FN)** located in the lower left-hand corner of the keyboard, and at the same time, press the **video toggle key**, which is located along the top of the keyboard. Look for the text **CRT/LCD** or an icon of a **display and a laptop**.

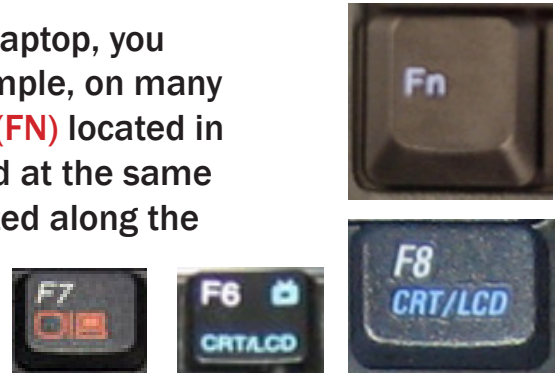

Examples of video toggle keys

For Mac Laptops:

- 1) Go to **System Preferences/Display**.
- 2) Select the **Arrangement** tab and check the **Mirror Displays** box.

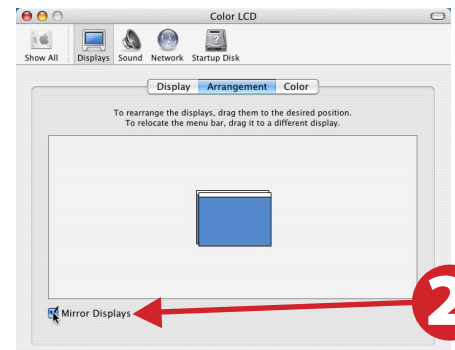

Powering Down the System

- 1) Press **Power** at the top right corner, then press **Yes**
- 2) Power down Computer

Windows

Start Menu -> Shut Down -> Click OK

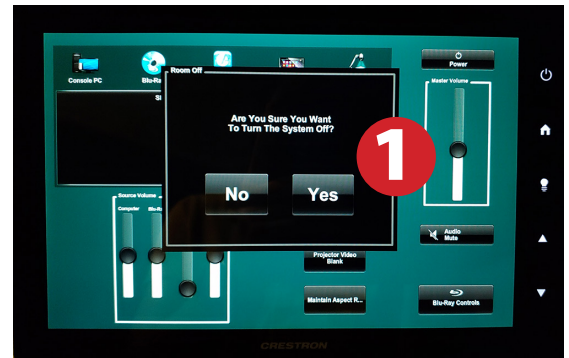

Who to Call for Assistance

If you are having any difficulties using equipment in this room, call extension **3166**