

# Smart Classroom Instructions

## BEHAVIORAL AND SOCIAL SCIENCES 204

If you are having difficulties using equipment in this room, call extension **3166**

### Projector

- 1) Obtain Epson Remote. Point (or aim) remote at projector on ceiling. Press power button once. *NOTE: Projector will take 30 seconds to power up.*
- 2) Lower screen using switch on the wall.

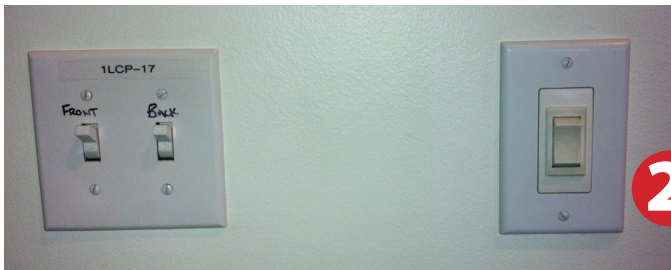

### Using Console Computer

- 1) Set video switch to Computer
- 2) Press **Power** button
- 3) Follow login instructions for:  
**Windows**
  - a. Control - Option - Delete
  - b. Click OK
  - c. Enter user name and password
  - d. Click Enter



## Using a Laptop

- 1) Turn on your laptop
- 2) Press Laptop button on video switch box
- 3) Connect the **Laptop Video cable** to the video output port on your laptop. (**HDMI** or **VGA**).
- 4) Connect your laptop's AC adapter to a power outlet and start up your laptop (Optional: An audio cable is provided for connecting your laptop to the speakers).
- 5) If you still do not see an image, refer to the **laptop troubleshooting guide** later in these instructions.
- 6) When finished, shut down your laptop and disconnect all cables.
- 7) Proceed to shutting down the rest of the equipment. Follow the instructions later in this guide, **Powering Down the System**.



2



4



# Sound and DVD/Blu-Ray

## Amplifier (sound)

- 1) Press **Power** button on left end of amplifier.
- 2) Make sure the **Speakers** button is set to A.
- 3) Adjust volume as needed.

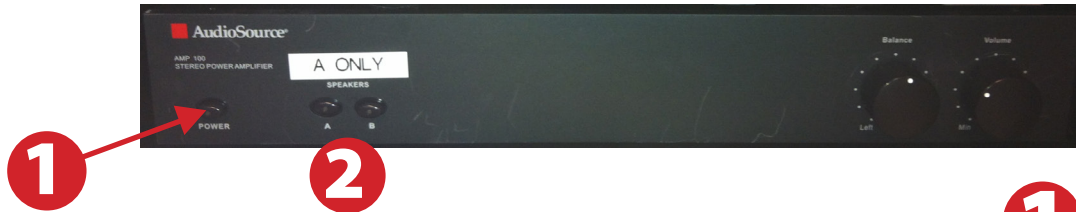

## Playing a DVD/Blu-Ray

- 1) Power on and control the Blu-Ray Player using the remote control
- 2) Insert media
- 3) Set video switch box to Blu-Ray
- 4) Set amplifier to Blu-Ray

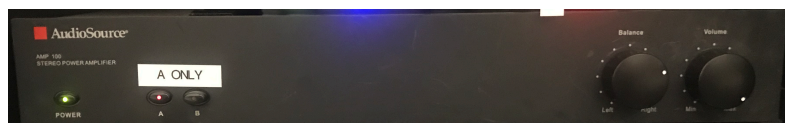
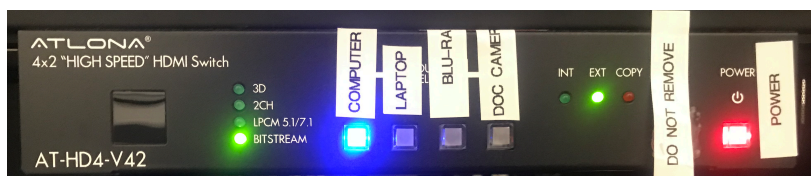

# Using the Document Camera

- 1) Set display switch box to **Doc Camera**.



1

- 2) Power on the **Document Camera**.  
Note that there is no need to have the computer turned on to use the document camera.



2

- 3) Press the **Live/Win** button to switch between showing the Windows desktop and showing the camera image full-screen.

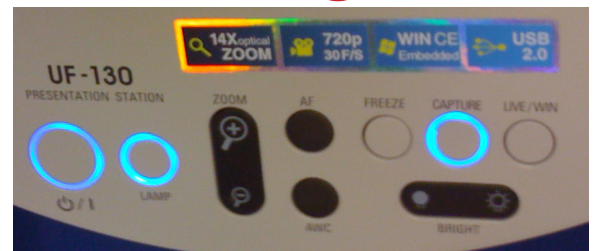



## Laptop Troubleshooting

**For PC Laptops:** Depending on your model of laptop, you may need to toggle the display mode. For example, on many laptops, you must hold down the **function key (FN)** located in the lower left-hand corner of the keyboard, and at the same time, press the **video toggle key**, which is located along the top of the keyboard. Look for the text **CRT/LCD** or an icon of a **display and a laptop**.



Examples of video toggle keys

**For Mac Laptops:**

- 1) Go to **System Preferences/Display**.
- 2) Select the **Arrangement** tab and check the **Mirror Displays** box.

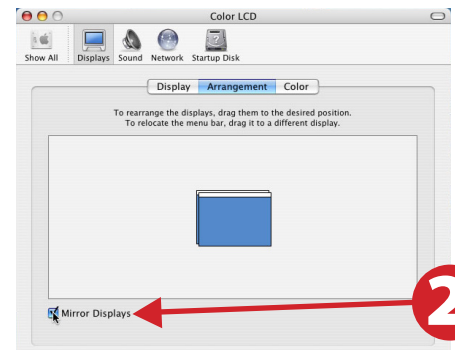

## Powering Down the System

- 1) Obtain the **Epson remote**, and point it at the projector on the ceiling. Press the power button to shut down the projector.
- 2) Power down Computer  
**Windows**  
Start Menu -> Shut Down -> Click OK
- 3) Raise screen



## Who to Call for Assistance

If you are having any difficulties using equipment in this room, call extension **3166**