

# Smart Classroom Instructions

## KINESIOLOGY & ATHLETICS 256

If you are having difficulties using equipment in this room, call extension **3166**

### Projector

- 1) Point Epson Remote at projector on ceiling. Press power button once. *NOTE: Projector will take about 30 seconds to power up.*
- 2) Set video switch to desired device - PC, laptop, DVD/VCR.

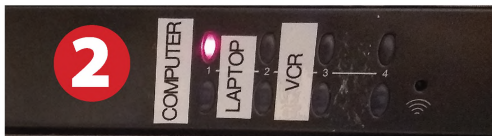

### Using Console Computer

- 1) Set video switch to PC
- 2) Press **Power** button on the PC
- 3) Follow login instructions for:  
**Windows**
  - a. Control - Alt - Delete
  - b. Click OK
  - c. Enter user name and password
  - d. Click Enter



## Using a Laptop

- 1) Turn on your laptop
- 2) Select Laptop on video switch box
- 3) Connect the **Laptop Video cable** to the video output port on your laptop.
- 4) For laptop audio, connect the **laptop audio cable** to your laptop's headphone jack. Make sure your laptop's audio is not muted.
- 5) Connect your laptop's AC adaptor to a power outlet and start up your laptop.
- 6) If you still do not see an image, refer to the **laptop troubleshooting guide** later in these instructions.
- 7) When finished, shut down your laptop and disconnect all cables.
- 8) Proceed to shutting down the rest of the equipment. Follow the instructions later in this guide, **Powering Down the System**.



# Sound and Video

## Amplifier (sound)

- 1) Press **Power** button on left end of amplifier. When the amplifier light is red, it is in **standby** mode. Amplifier power is on when the light is blue
- 2) Select **PC** if you're using the console PC, **DVD/VCR** if you're using the DVD VCR, and **Laptop** if you're using a laptop
- 3) Adjust volume as needed.



## Playing a DVD/VHS Tape

- 1) Set video switch to DVD/VCR.
- 2) Set amplifier to DVD/VCR.
- 3) Press player **Power** button
- 4) Insert media.
- 5) Use **Player remote** to select media type (DVD or VCR) - controls on remote will change to selected media device.

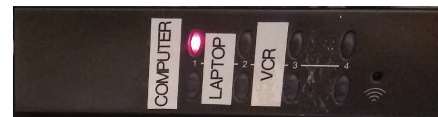

3



## Using Closed Captioning

- 1) For **DVDs**, use the DVD remote and the DVD menu to set closed captioning or subtitle options.
- 2) For **VHS videocassettes**, set the closed caption device switch to the CC1 position.

When finished with video, please set the switch to the Off position.





## Laptop Troubleshooting

**For PC Laptops:** Depending on your model of laptop, you may need to toggle the display mode. For example, on many laptops, you must hold down the **function key (FN)** located in the lower left-hand corner of the keyboard, and at the same time, press the **video toggle key**, which is located along the top of the keyboard. Look for the text **CRT/LCD** or an icon of a **display and a laptop**.

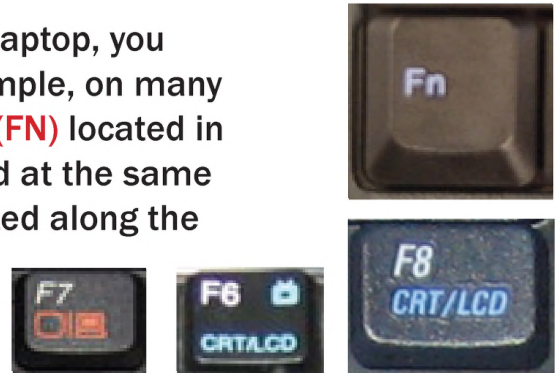

Examples of video toggle keys

**For Mac Laptops:**

- 1) Go to **System Preferences/Display**.
- 2) Select the **Arrangement** tab and check the **Mirror Displays** box.

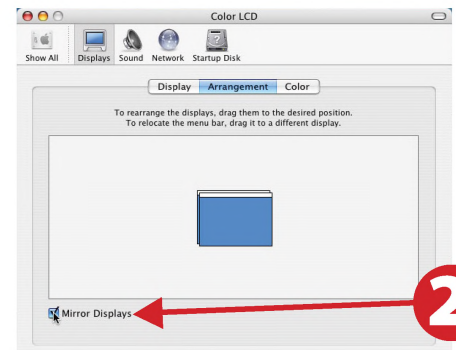

## Powering Down the System

- 1) Obtain the **Epson remote**, and point it at the projector on the ceiling. Press the power button to shut down the projector.
- 2) Power down Computer

**Windows**

Start Menu -> Shut Down ->  
Click OK



## Who to Call for Assistance

If you are having any difficulties using equipment in this room, call extension **3166**