

Smart Classroom Instructions

SCIENCE B 135

Powering Up the System

- 1) To start the tablet, **press the Power button** on the tablet
- 2) Power up left & right projectors
- 3) Power up the PC
Follow login instructions for:
Windows
 - a. Control - Alt - Delete
 - b. Click OK
 - c. Enter user name and password
 - d. Click Enter

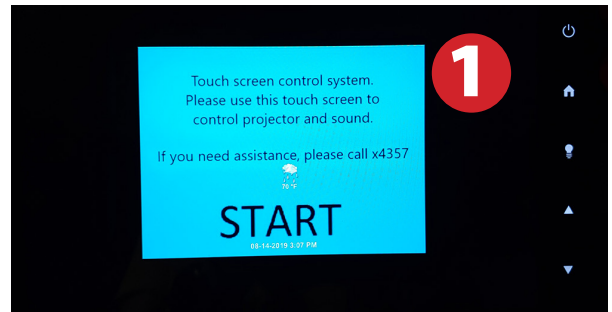

Using the Headphone Minijack

- 5) Plug in Aux cable. Adjust **External Audio**



Using Console Computer

- 1) Drag the **Computer** button to the center of tablet
- 2) Press **Power** button (in the upper left corner)



Using a Laptop or HDMI Device

- 1) Turn on your laptop
- 2) Drag **HDMI Laptop** to left or right projector
- 3) Connect the **HDMI cable** to the video output port on your laptop
- 4) Connect your laptop's AC adaptor to a power outlet and start up your laptop
- 5) If you still do not see an image, refer to the **laptop troubleshooting guide** later in these instructions
- 6) When finished, shut down your laptop and disconnect all cables
- 7) Proceed to shutting down the rest of the equipment. Follow the instructions later in this guide, **Powering Down the System**



Blu-Ray and DVD

- 1) Drag **Blu-Ray** icon to the left/right projector source on tablet
- 2) Insert media
- 3) Use Blu-Ray controls button on tablet to control playback

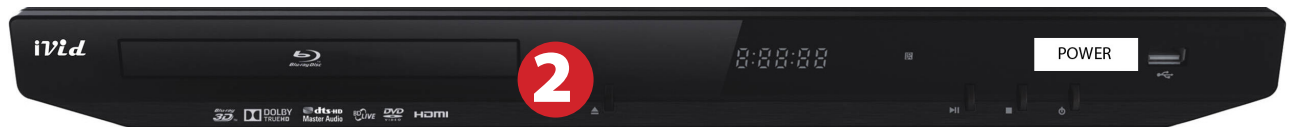
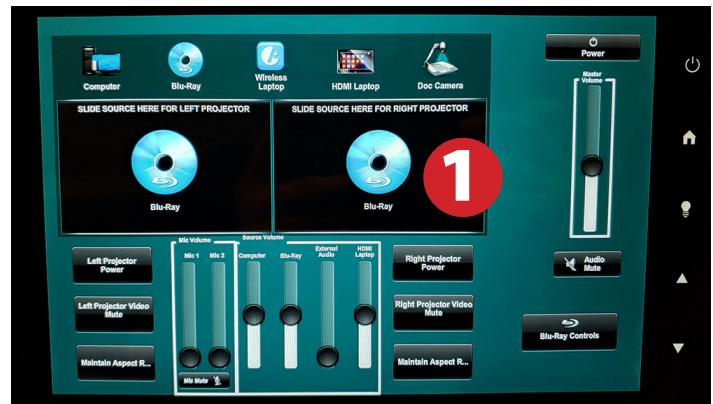

Using the Document Camera

- 1) Drag **Doc Camera** icon to the left/right projector source on the tablet
- 2) Power on the **Document Camera**. Note that there is no need to have the computer turned on to use the document camera



Using a Microphone

- 1) Open the microphone storage case.
- 2) Choose the lapel microphone.
- 3) Make sure that the Level knobs always stay pointed up.



Laptop Troubleshooting

For PC Laptops: Depending on your model of laptop, you may need to toggle the display mode. For example, on many laptops, you must hold down the **function key (FN)** located in the lower left-hand corner of the keyboard, and at the same time, press the **video toggle key**, which is located along the top of the keyboard. Look for the text **CRT/LCD** or an icon of a **display and a laptop**.

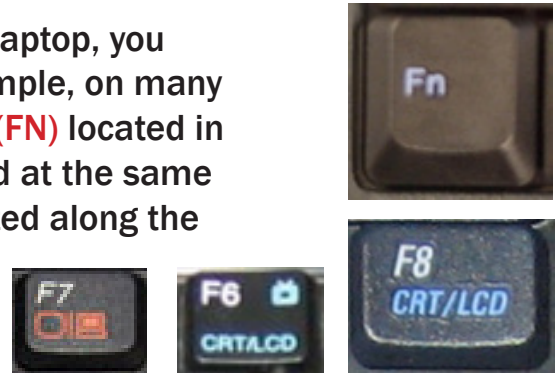

Examples of video toggle keys

For Mac Laptops:

- 1) Go to **System Preferences/Display**.
- 2) Select the **Arrangement** tab and check the **Mirror Displays** box.

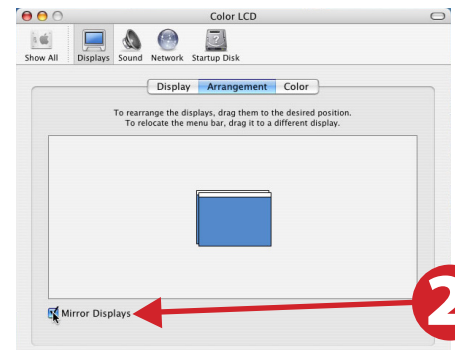

Powering Down the System

- 1) Press the **Power** button on the tablet then press **Yes**
- 2) Power down Computer

Windows

Start Menu -> Shut Down -> Click OK

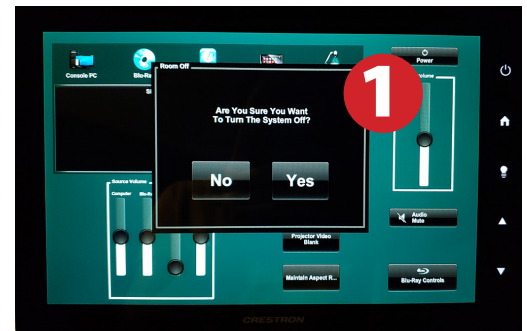

Who to Call for Assistance

If you are having any difficulties using equipment in this room, call extension **3166**