

Smart Classroom Instructions

SIEMENS HALL 108

Powering Up the System

- 1) To start the tablet, **press the Power button** on the tablet
- 2) Choose from **PC, Blu-Ray, Laptop, HDMI** or **Doc Cam** to drag into the box for main projector
- 3) Press **Projector Power** to turn on projector for display
- 4) Volume, Microphone, Aspect Ratio and Blu-Ray controls will be readily accessible for whatever source you use on the tablet

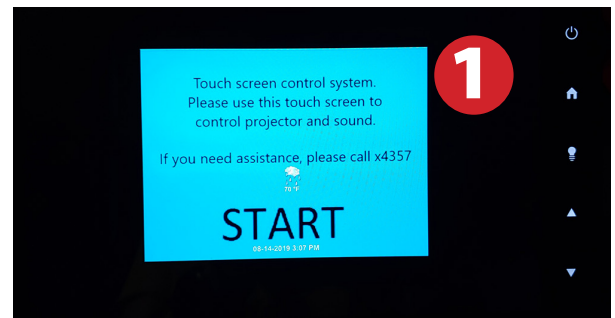

Using Console Computer

- 1) Drag the **Computer button** to the center of tablet
- 2) Press **Power** button (in the upper left corner)

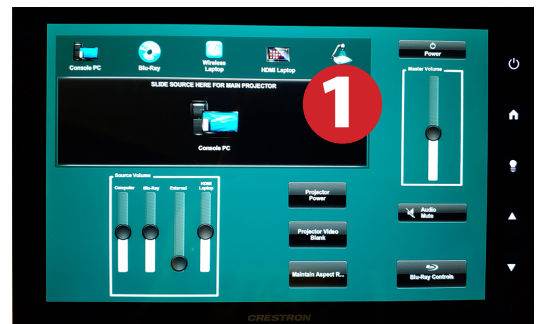

Using a Laptop or HDMI Device

- 1) Turn on your laptop
- 2) Drag **HDMI Laptop** to projector source
- 3) Connect the **VGA Cable** or the **HDMI cable** to the video output port on your laptop.
- 4) Connect your laptop's AC adaptor to a power outlet and start up your laptop
- 5) If you still do not see an image, refer to the **laptop troubleshooting guide** later in these instructions
- 6) When finished, shut down your laptop and disconnect all cables
- 7) Proceed to shutting down the rest of the equipment. Follow the instructions later in this guide, **Powering Down the System**

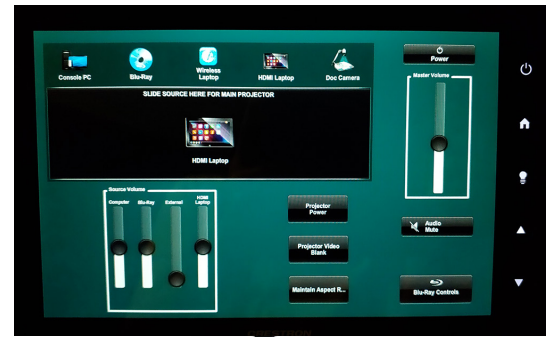

Using the Document Camera

- 1) Drag **Doc Camera** icon to the center of the tablet
- 2) Power on the **Document Camera**. Note that there is no need to have the computer turned on to use the document camera

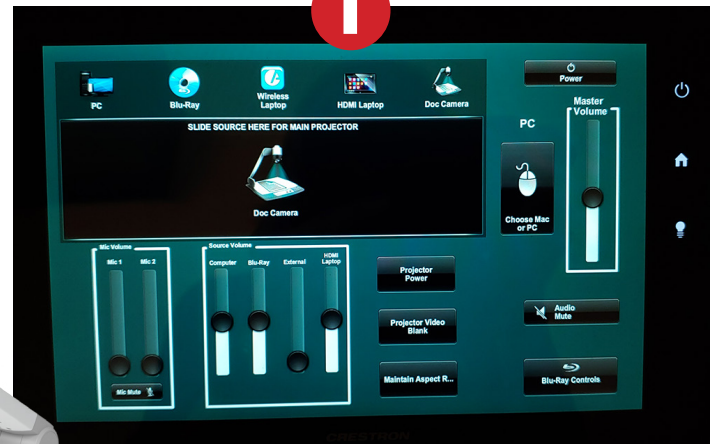

Laptop Troubleshooting

For PC Laptops: Depending on your model of laptop, you may need to toggle the display mode. For example, on many laptops, you must hold down the **function key (FN)** located in the lower left-hand corner of the keyboard, and at the same time, press the **video toggle key**, which is located along the top of the keyboard. Look for the text **CRT/LCD** or an icon of a **display and a laptop**.

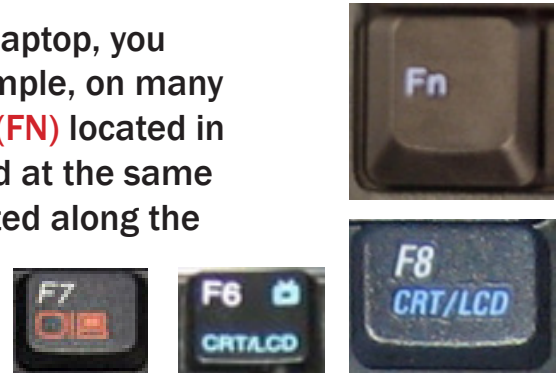

Examples of video toggle keys

For Mac Laptops:

- 1) Go to **System Preferences/Display**.
- 2) Select the **Arrangement** tab and check the **Mirror Displays** box.

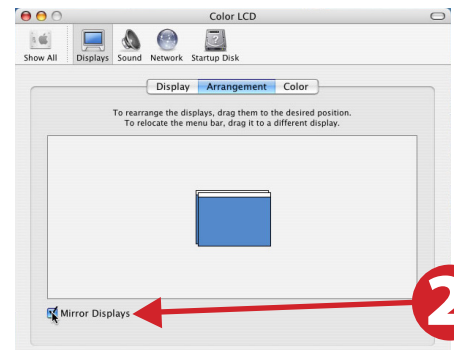

Powering Down the System

- 1) Power down Computer
Windows
Start Menu -> Shut Down -> Click OK
- 2) Press the **Power** button on the tablet then press **Yes**

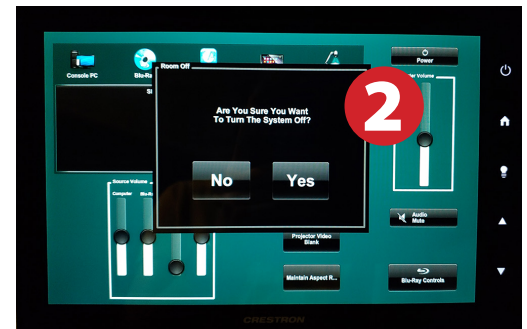

Who to Call for Assistance

If you are having any difficulties using equipment in this room, call extension **3166**