

Smart Classroom Instructions

SIEMENS HALL 115

*If you are having difficulties using equipment in this room, call extension **3166***

Projector

- 1) Press the **On** button on the control panel.
- 2) Press button for desired device –Computer, Laptop, HDMI, Audio Input, DVD/Blu-Ray or Document Camera.
- 3) Screen controls are to the right of the white-board.



Using Console Computer

- 1) Press **Power** button (in the upper right corner)
- 2) Press **Computer** button
- 3) Follow login instructions for:
Windows
 - a. Control - Option - Delete
 - b. Click OK
 - c. Enter user name and password
 - d. Click Enter

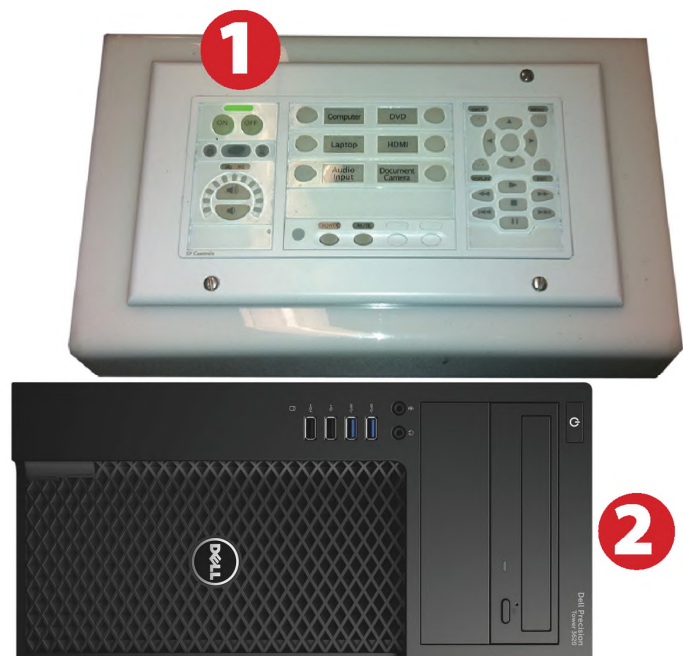

Using a Laptop

- 1) Turn on your laptop
- 2) Press Laptop button on control panel
- 3) Connect the **Laptop Video cable** to the video output port on your laptop (**HDMI** or **VGA**).
- 4) Connect **Aux Cord** to Laptop for sound.
- 5) Connect your laptop's AC adapter to a power outlet and start up your laptop.
- 6) If you still do not see an image, refer to the **laptop troubleshooting guide** later in these instructions.
- 7) When finished, shut down your laptop and disconnect all cables.
- 8) Proceed to shutting down the rest of the equipment. Follow the instructions later in this guide, **Powering Down the System**.



Sound and DVD/Blu-Ray

Using the Headphone Minijack

- 1) Set control panel to **Audio Input**
- 2) Connect minijack to device
- 3) Adjust volume as needed on the control panel.



Playing a DVD/Blu-Ray

- 1) Power on and control the Blu-Ray Player using the remote control
- 2) Insert media
- 3) Set video switch box to Blu-Ray

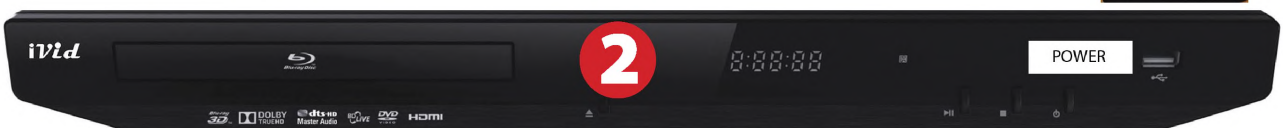

Using an HDMI Device

An HDMI cable is provided for connecting devices such as some laptops, iPads/iPhones and Android devices.

1) Press the **HDMI** button on the control panel.



2) Connect your device to the HDMI cable.



Please note: Certain devices, such as iPhones and iPads, will require an HDMI adaptor. Consult your owner's manual for further information.

Using the Document Camera

1) Press the **Doc Camera** button on the control panel.

2) Power on the **Document Camera**.
Note that there is no need to have the computer turned on to use the document camera.

3) Press the **Live/Win** button to switch between showing the Windows desktop and showing the camera image full-screen.



2

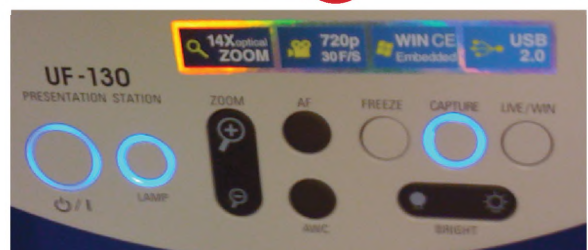

Laptop Troubleshooting

For PC Laptops: Depending on your model of laptop, you may need to toggle the display mode. For example, on many laptops, you must hold down the **function key (FN)** located in the lower left-hand corner of the keyboard, and at the same time, press the **video toggle key**, which is located along the top of the keyboard. Look for the text **CRT/LCD** or an icon of a **display and a laptop**.

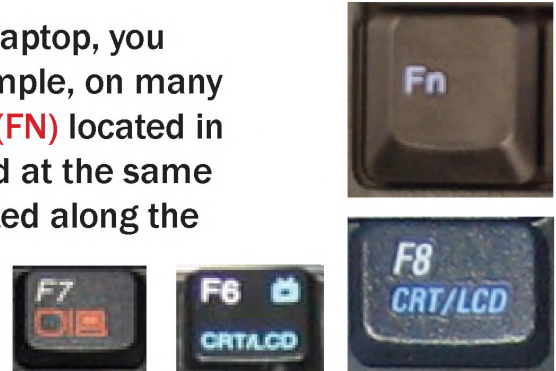

Examples of video toggle keys

For Mac Laptops:

- 1) Go to **System Preferences/Display**.
- 2) Select the **Arrangement** tab and check the **Mirror Displays** box.

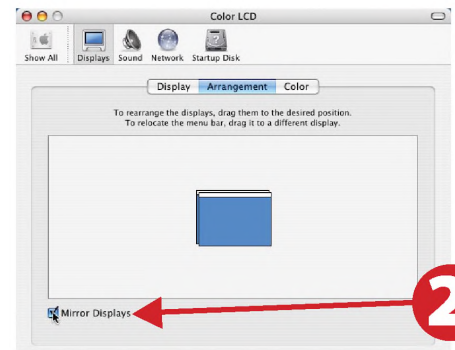

Powering Down the System

- 1) Press the Off button on the control panel to shut down the projector
- 2) Power down Computer

Windows

Start Menu -> Shut Down -> Click OK



Who to Call for Assistance

If you are having any difficulties using equipment in this room, call extension **3166**