

Smart Classroom Instructions

SIEMENS HALL 117

If you are having difficulties using equipment in this room, call extension **3166**

Projector

- 1) Press the On button on the projector controls.
- 2) Lower screen with switch to the right of the white-board if not already lowered.
- 3) Set switch to desired device –
Computer, Laptop, HDMI, Document Camera.

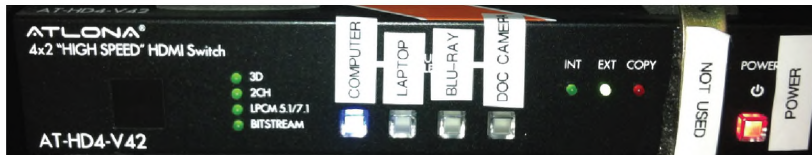

1



3

Using Console Computer

- 1) Set switch to Computer
- 2) Press **Power** button (in the upper right corner)
- 3) Follow login instructions for:
Windows
 - a. Control - Option - Delete
 - b. Click OK
 - c. Enter user name and password
 - d. Click Enter

1



2



Using a Laptop

- 1) Turn on your laptop.
- 2) Set display switch box to:
Laptop
- 3) Connect the **Laptop Video cable** to the video output port on your laptop (**HDMI** or **VGA**).
- 4) Connect your laptop's AC adapter to a power outlet and start up your laptop.
- 5) If you still do not see an image, refer to the **laptop troubleshooting guide** later in these instructions.
- 6) When finished, shut down your laptop and disconnect all cables.
- 7) Proceed to shutting down the rest of the equipment. Follow the instructions later in this guide, **Powering Down the System**.

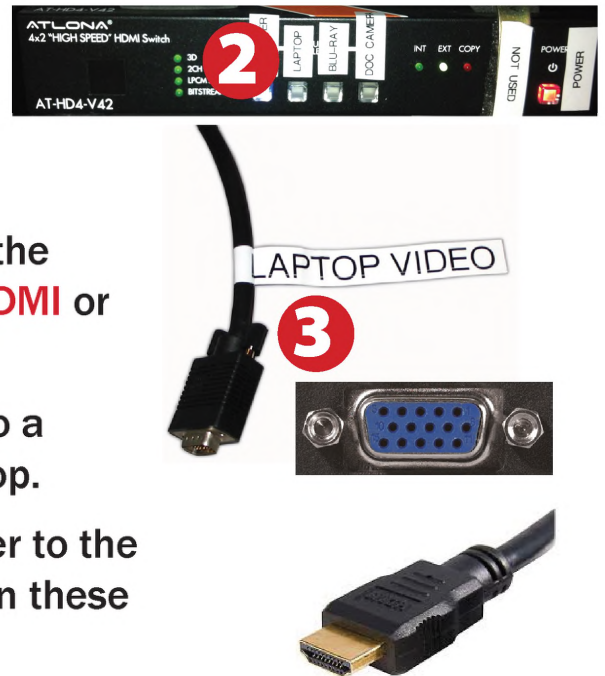

Sound and DVD/Blu-Ray

Amplifier (sound)

- 1) Press **Power** button on left end of amplifier.
- 2) Make sure the **Speakers** button is set to A.
- 3) Adjust volume as needed.

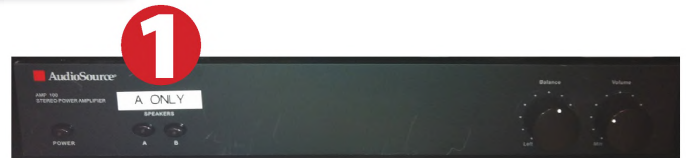

Playing a DVD/Blu-Ray

- 1) Press the power button and eject button on the DVD player.
- 2) Insert media.
- 3) Use the remote to control the DVD.

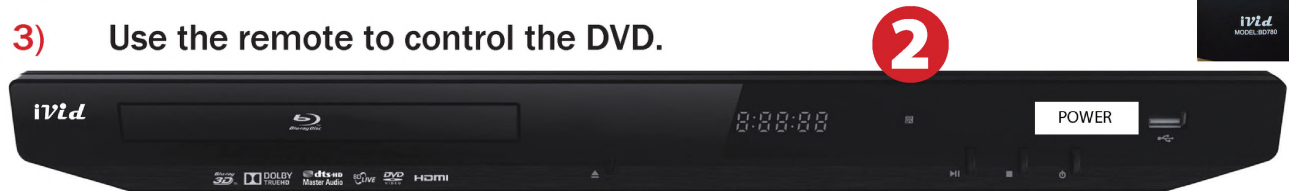

Using the Document Camera

- 1) Set display switch box to **Doc Camera**.
- 2) Power on the **Document Camera**. Note that there is no need to have the computer turned on to use the document camera.
- 3) Press the **Live/Win** button to switch between showing the Windows desktop and showing the camera image full-screen.



Using an HDMI Device

An HDMI cable is provided for connecting devices such as some laptops, iPads/iPhones and Android devices.

- 1) Set display switch box to **HDMI**.



- 2) Connect your device to the HDMI cable.



Please note: Certain devices, such as iPhones and iPads, will require an HDMI adaptor. Consult your owner's manual for further information.

Laptop Troubleshooting

For PC Laptops: Depending on your model of laptop, you may need to toggle the display mode. For example, on many laptops, you must hold down the **function key (FN)** located in the lower left-hand corner of the keyboard, and at the same time, press the **video toggle key**, which is located along the top of the keyboard. Look for the text **CRT/LCD** or an icon of a **display and a laptop**.



Examples of video toggle keys

For Mac Laptops:

- 1) Go to **System Preferences/Display**.
- 2) Select the **Arrangement** tab and check the **Mirror Displays** box.

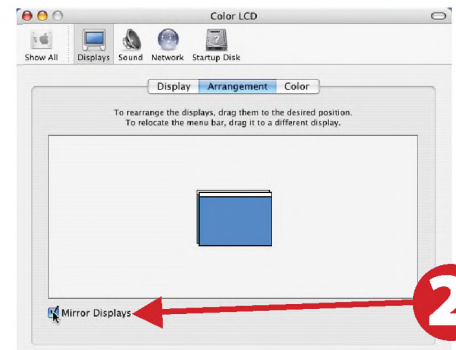

Powering Down the System

- 1) Press the Off button on the projector controls
- 2) Power down Computer
Windows
Start Menu -> Shut Down -> Click OK
- 3) Raise screen

1



Who to Call for Assistance

If you are having any difficulties using equipment in this room, call extension **3166 (HELP)**